

FORM No. 1.

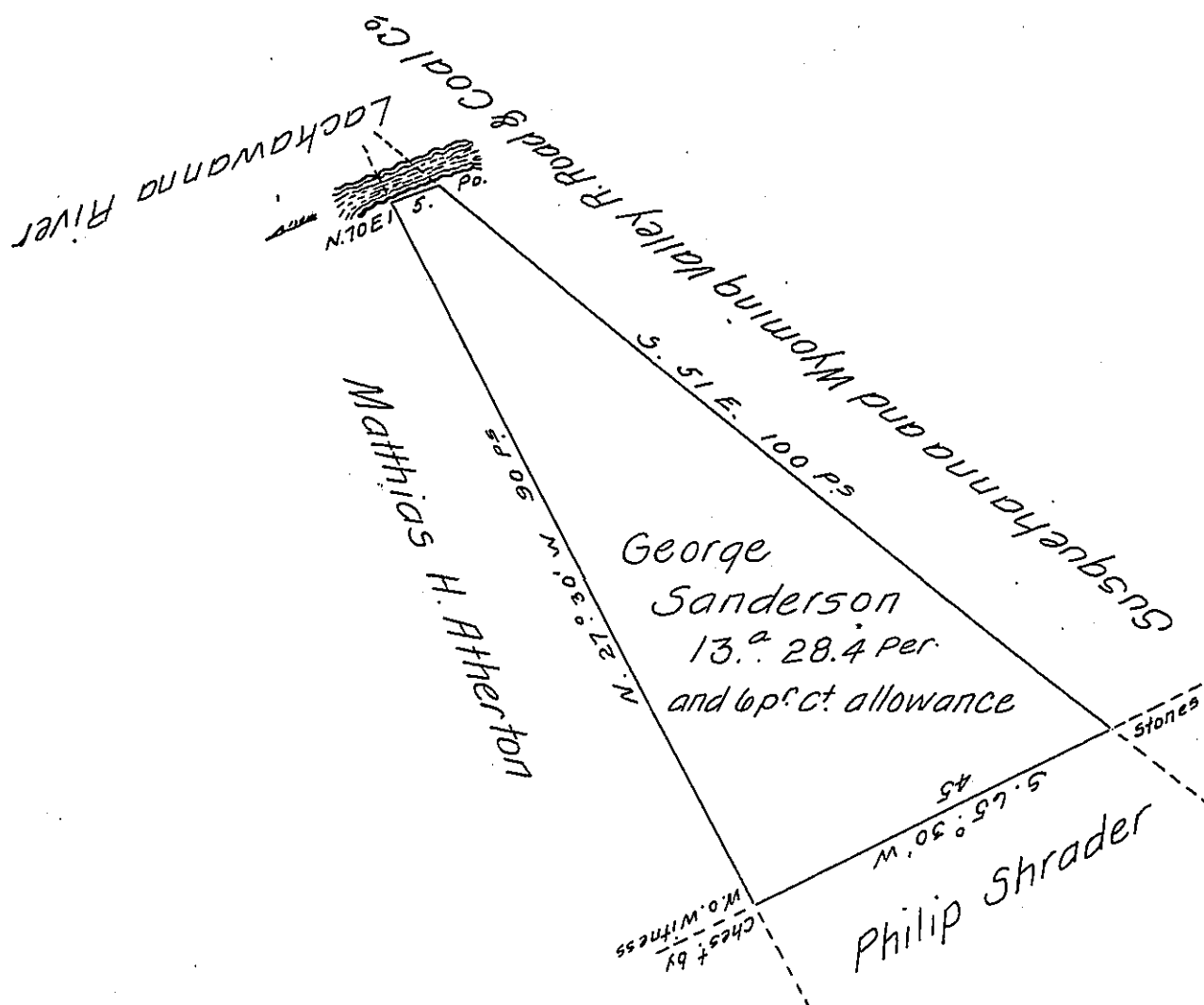

Draft of a tract or lot of land situate in the township of Lackawanna County of Luzerne Pa. bounded on the North ^{by Land} in possession of the "Susquehanna and Wyoming Coal Co" on the East by a tract of Land in the Warranty name of Philip Shrader. on the South by a tract of Land in the Warranty name of Matthias H. Atherton, and Westerly by Lackawanna Creek. having a small improvement thereon of about one acre, and containing thirteen Acres and twenty eight perches and four tenths, and allowance of 6 p. ct.

Surveyed the above lot to George Sanderson on the 27th day of May 1861. in pursuance of his Warrant dated 9th May 1861.

To Hon. William H. Keim	John Sturdevant
Surveyor General.	Surveyor for Luzerne County.

IN TESTIMONY that the above is a copy of the original remaining on file in the Department of Internal Affairs of Pennsylvania, made conformably to an Act of Assembly approved the 16th day of February 1833, I have hereunto set my hand and caused the Seal of said Department to be affixed at Harrisburg, this twenty third day of January 1908.

Henry Howck
 Secretary of Internal Affairs.